



- Dimmable 120V LED strip, great for lighting long runs up to 164 feet
- CRI 90+
- Custom, proprietary channel, frosted or clear lens ([clear is special order](#)), and aluminum endcaps to create a finished fixture. Also can be mounted with simple plastic clips.
- Indoor and outdoor use. Perfect for outline, cove, architectural, and landscape applications (see notes for detail).
- UV resistant
- ETL listed with hardwire or plug
- Over voltage, over current, and over temperature protection

## THE COMPLETE ASSEMBLED SOLUTION

1. Select LED strip
2. Select channel and lens

Project Name \_\_\_\_\_

Fixture Type \_\_\_\_\_

Phase \_\_\_\_\_

Specifier \_\_\_\_\_

Date \_\_\_\_\_

SKU \_\_\_\_\_

SKU \_\_\_\_\_

SKU \_\_\_\_\_

SKU \_\_\_\_\_

## PERFORMANCE

Special Order (NF/SP) allow 7-9 weeks for delivery; MOQ is 164'

SKU	CCT	Lumens/ft	Efficacy (lm/w)	Power (w/ft)
NF-LINE2-0-80-120V-2700K	2700K	397	89	4.5
NF-LINE2-0-80-120V-3000K	3000K	412	91	4.6
NF-LINE2-0-80-120V-3500K	3500K	414	91	4.5
NF-LINE2-0-80-120V-4000K	4000K	425	94	4.5
NF/SP-LINE2-0-80-120V-5000K	5000K	394	88	4.5

Lumens have a tolerance of ±10%

## ELECTRICAL

Voltage	120V
Wire Size	18 AWG, 2 Wire
Lead	1.64 ft or 4.92 ft
Jumper	3in, 6in, 9in, 12in, 24in, 48in
Dimming	Compatible Dimmers <i>Take care not to exceed the dimmer's power rating, recommended max run lengths noted below:</i>  Triac, Lutron DVCL-153P (max 133') Triac, Lutron DVELV-300P (max 66') Triac, Lutron DVLV-10P (all lengths, up to 164' max run of strip)

## PHYSICAL

Operating Temp	-4° to 113°F (-20° to 45°C)
Environment	Damp or Wet, IP65
Mounting	Channel and lens or mounting clips
Cut Length	4 in
Bend Radius	≥3.94 in (Top - Vertical Bend)
Max Run	164 ft

## QUALITY ASSURANCE

CCT Binning	3-Step MacAdam
Warranty	3 years*
Certifications	ETL Listed
Lumen Maintenance	Indoor 50,000 Hrs, Outdoor 36,000 Hrs

## LIGHT DISTRIBUTION (3000K)

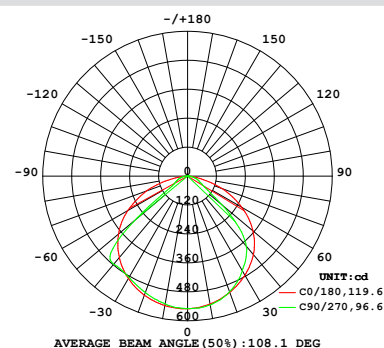

CRI/R9 @ 3000K 93/66

Rf/Rg @ 3000K 92/99

Beam Angle

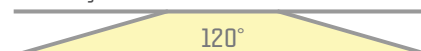

DOWNLOAD FULL 120V LINE 2.0  
PHOTOMETRIC DATA HERE

## DIMENSIONS

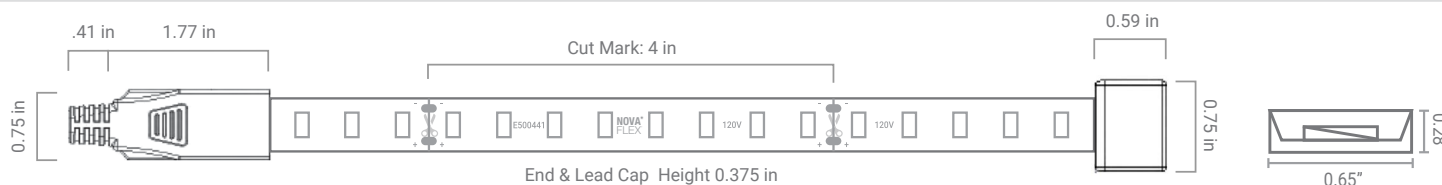

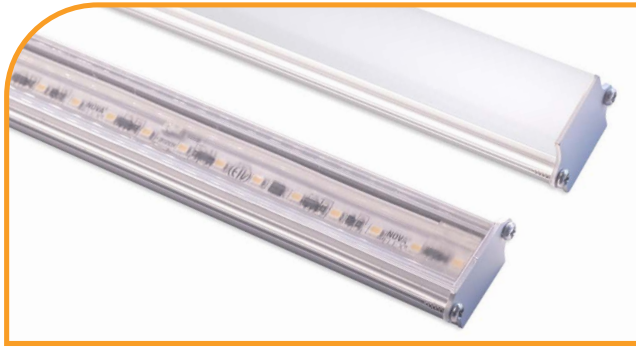

TYPE: Surface Mount  
COLOR: Silver  
LENS: Frosted, Clear  
(frosted is dot free)

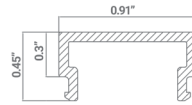
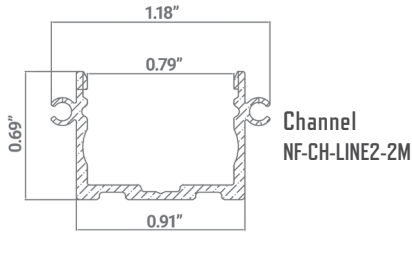

Frosted lens  
NF-CH-LINE2-C/SOFT-2M

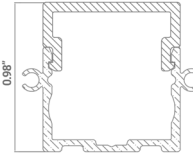

Channel with  
frosted lens

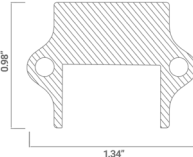

Frosted channel  
endcap - wired end

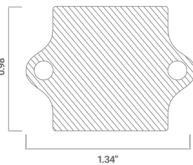

Frosted channel  
endcap -  
non-wired end

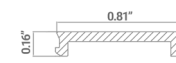

Clear lens  
NF/SP-CH-LINE2-C/CLEAR-2M

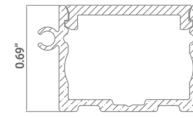

Channel with  
clear lens

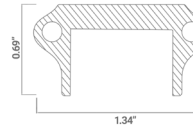

Clear channel  
endcap - wired end

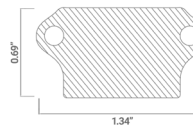

Clear channel  
endcap -  
non-wired end

## INSTALLATION & MOUNTING: CHANNEL, LENS, & ENDCAPS

INSTALL VIDEO

- This mounting option (with channel, lens, and endcaps) is suitable for indoor use, and for outdoor locations that aren't directly exposed to rain and snow. Direct exposure to rain and snow can lead to water entering and pooling in the channel, which can impact performance and life.
- For long runs, we recommend at least two people for installation.
- 3M advises that proper bond for this VHB tape occurs after 72 hours.
- The 120V strip on its non-wired end will rest inside the channel, flush against the inside edge of the channel's aluminum endcap as shown in **image A**. The aluminum endcap to use on this end is the one without a hole.
- The 120V strip on its opposite, wired end should be oriented as shown in **image B**. The aluminum endcap to use on this end is the one with the hole.



1. Direct mount the channel to the surface with screws.
2. Clean the inside of the channel with a 50/50 mix of water and isopropyl alcohol, and let it dry. This ensures an optimal bond for the VHB tape.
3. Install the aluminum endcap that doesn't have a hole (for the non-wired end) to the channel with two screws. These are self-tapping screws that must be properly centered. **We recommend use of a magnetic screwdriver with reasonable grip and length to ensure proper leverage, and easier centering and driving of the screws.**
4. Remove the protective backing from the VHB tape on the 120V strip, and affix the 120V strip to the channel, starting with the non-wired end (the lens should rest flush against the inside edge of the endcap, per **image A**). Apply even, steady pressure to the 120V strip to ensure it properly bonds to the channel.
5. Carefully install the clear flat or raised frosted lens. Starting at the non-wired end in which one endcap has been installed, and gradually working towards the other end, press the lens into the channel.
6. After ensuring that the lens is securely in place, install the aluminum endcap with the hole at the wired end, on the opposite end of the channel. **We recommend use of a magnetic screwdriver with reasonable grip and length to ensure proper leverage, and easier centering and driving of the screws.**

## INSTALLATION: PLASTIC CLIPS NF-LINE2-CLIP-KIT

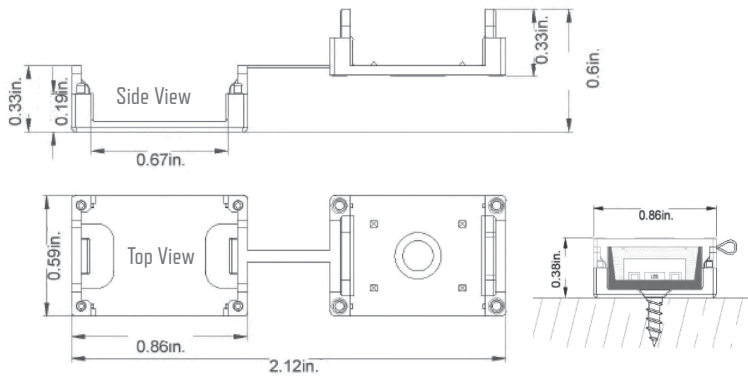

- Mounting with clips is suitable for indoor use, and for outdoor use in locations that are directly exposed to rain and snow, as long as there is adequate drainage, such that the LED strip won't be submerged.
- For long runs, we recommend at least two people for installation
- The VHB tape is optional when mounting with plastic clips. Thus the polyethylene backing on the tape does not need to be removed, unless the VHB tape will be used.

1. Fix the clip to the mounting surface with a screw. We recommend one clip on each end of the run placed just inside the end caps and one clip every 12 inches.
2. Starting at one end, insert the 120V strip into the open clip, then snap both sides of the clip's top cover into place. Repeat for each clip along the run.

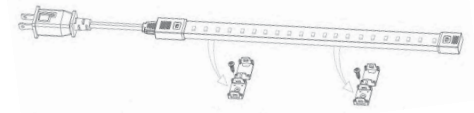

## INSTALLATION: DIMMERS

Follow all notes in the install guide supplied with the dimmer. Use only with hardwired installation. **DO NOT INSTALL DIMMER TO control outlets / plug-in receptacles or use with other loads.**

## LUTRON DVCL-153P

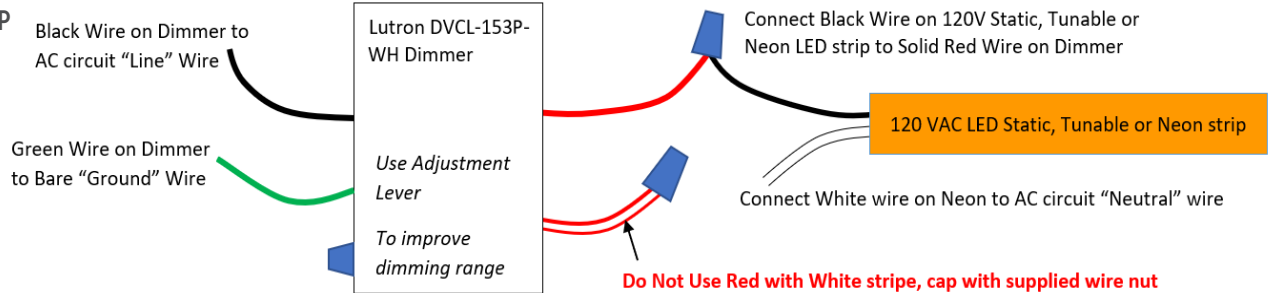

## LUTRON DVELV-300P

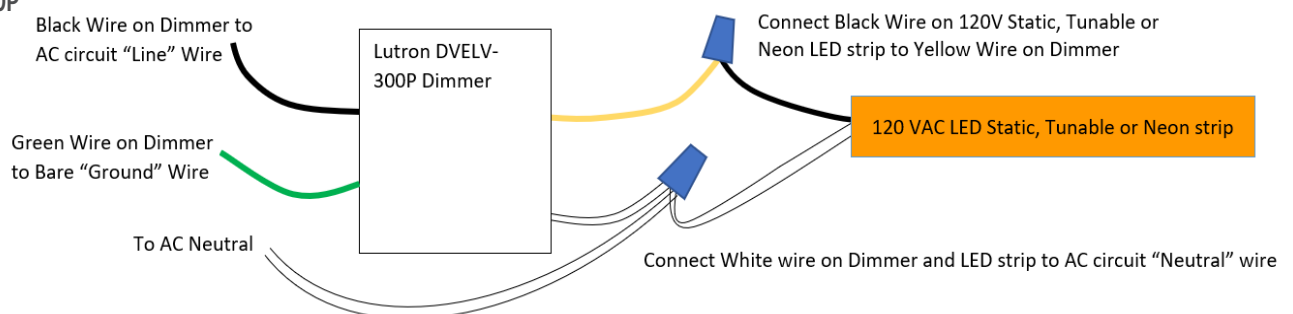

## LUTRON DVLV-10P

